

# REPORT TO WAVERLEY TRAFFIC COMMITTEE

## Cuthbert Street, Queens Park- Removal of “No Stopping” (A02/0637- 02)

Report dated 15 October 2010 from the Divisional Manager, Technical Services detailing a proposal to remove a “No Stopping” zone at the very eastern end of Cuthbert Street at Blenheim Street, Queens Park.

**Council’s Proposal:** That the existing No Stopping sign outside No.56A Blenheim Street be removed and replaced with “2P 8:00am-6:00pm Mon-Sat Authorised Residents vehicles Excepted Area 23” zone.

---

### Purpose of Report

Council has received representations from a resident requesting consideration be given to removing a “No Stopping” sign that was installed earlier this year at the very eastern end of Cuthbert Street just to the south of Blenheim Street in order to create two parallel parking spaces in an area of high, week day parking demand. Council will be required to exercise its delegated functions to implement the proposal.

### Introduction

A request has been received from a resident of Cuthbert Street, Queens Park for Council to review parking controls at the very eastern end of the street. It appears a “No Stopping” sign (arrow right) was installed earlier this year by RTA crews in the vicinity of property No. 56A Blenheim Street to stop vehicles from being parked illegally at an angle to the kerb too close to the southern end of the narrow, Blenheim Street. An on-site inspection revealed that the existing “No Stopping” zone can be removed and vehicles be permitted to park parallel in that zone which will provide two valuable parking spaces.

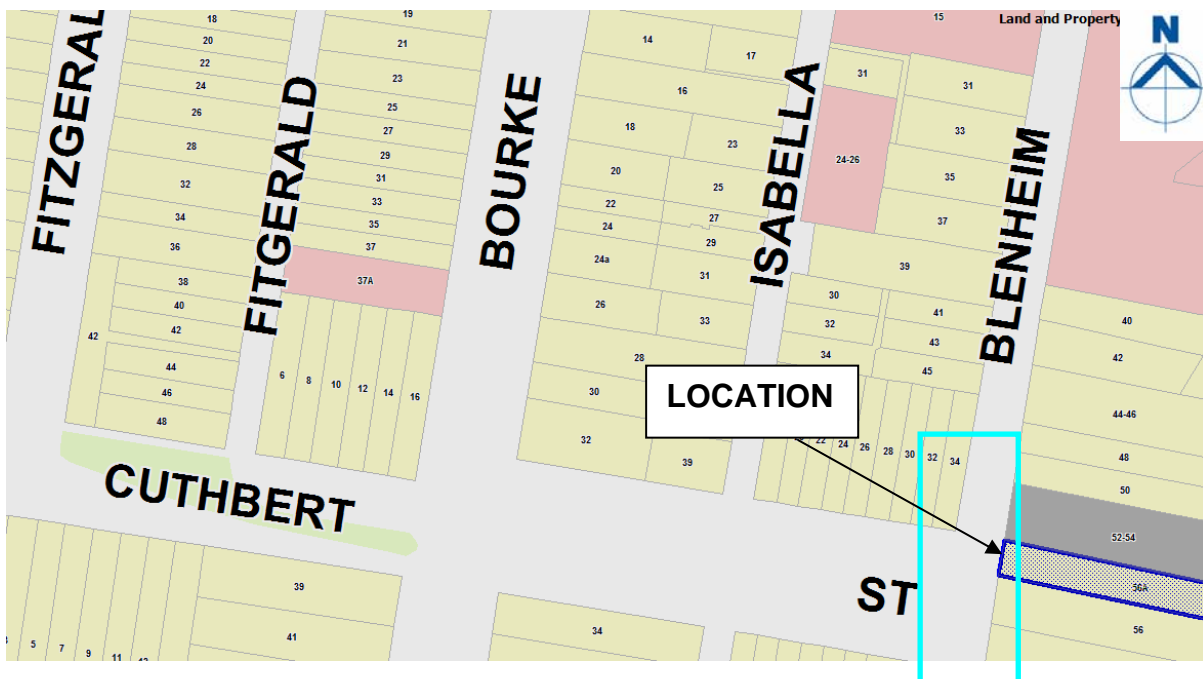

# REPORT TO WAVERLEY TRAFFIC COMMITTEE

## Technical Analysis

A “No Stopping” sign with right arrow right is understood to have been installed earlier this year by RTA crews to stop vehicles being parked illegally at right angles to the road too close to the southern end of narrow Blenheim Street.

There is an area of signposted, 90 degree angle parking in the south-eastern corner of Cuthbert Street for the parking of some 4-5 vehicles however, drivers up until earlier in the year were frequently parking vehicles at an angle further to the north of the designated angle parking area and close to the southern end of one way south, Blenheim Street.

Parking at an angle too close to Blenheim Street narrowed the carriageway significantly making it difficult for larger vehicles to exit that street.

## Existing Parking Plan

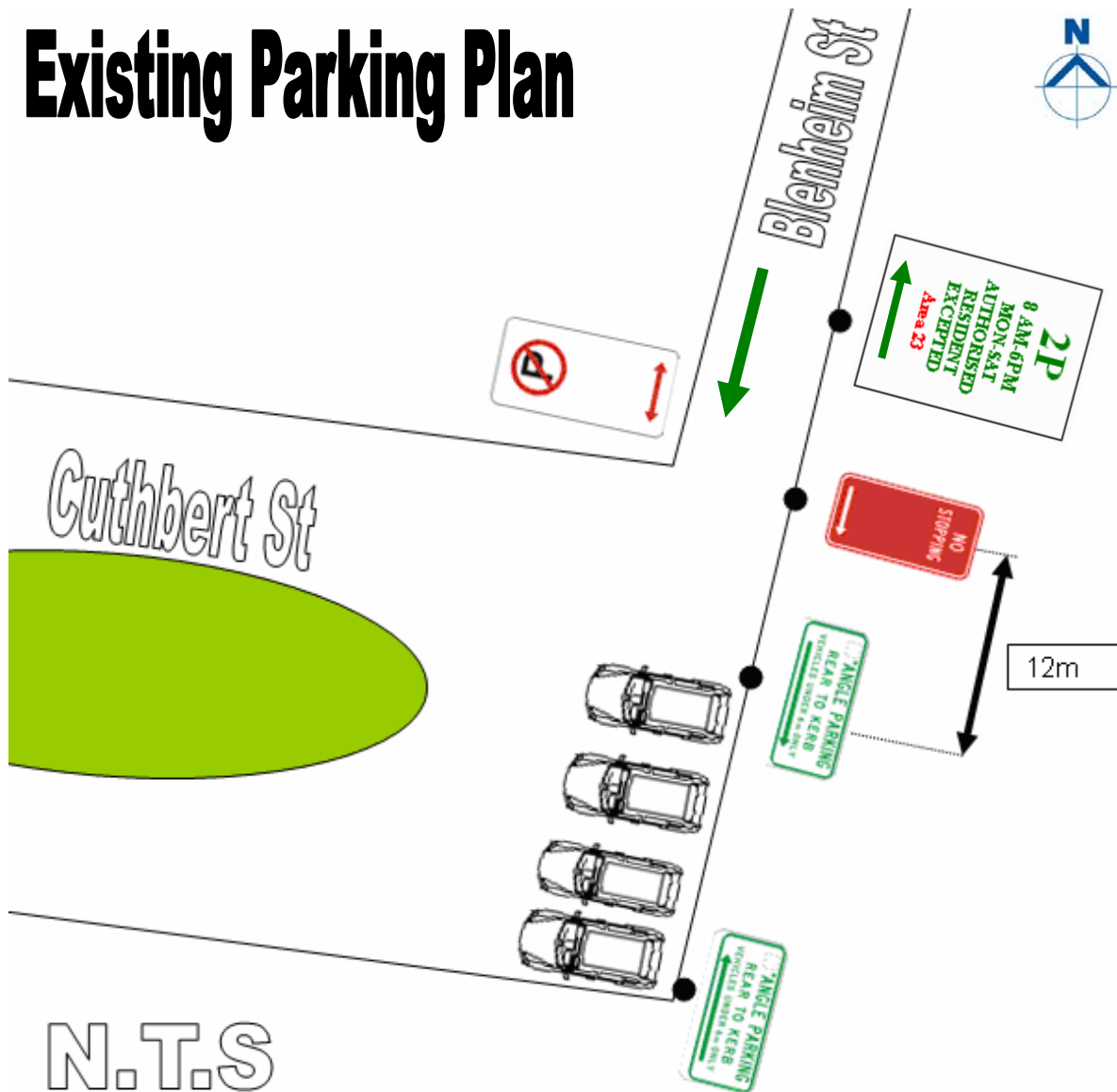

It is considered the installation of the “No Stopping zone is unnecessary and should be removed so the zone can be used for parallel parking.

Council’s Parking Patrol Officers have raised concern regarding the “No Stopping: sign being installed on its own with no closing “ No Stopping” arrow left sign to the south.



REPORT TO WAVERLEY TRAFFIC COMMITTEE

